

5	Screw	Steel	Ni	M2.6
4	Wafer Terminal	Brass	TIN	1/2H
3	Contact Terminal	Brass	TIN	EH
2	Cage Terminal	Brass	TIN	H
1	Base	N-66		UL94 V0
	Part Name	Material	Plating	Remark

Current rating	AC250V 6Amp
Insulation resistance	500M Ohms of More at DC500V
Withstand voltage	AC2000V/Minute
Wire range	AWG #18-#26
Torque	4.0 lb-in

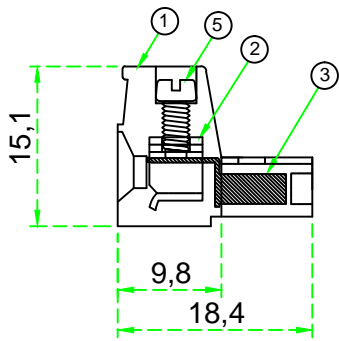

(BI-508PIB-**-P)

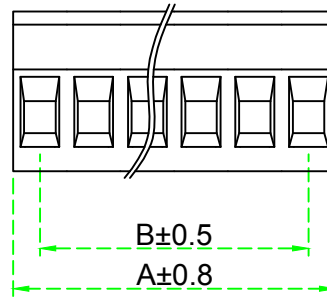

▶ 4, 5, 7, 8, 9p
= 커팅면
▶ 2, 3, 6, 10p
= One Mold

(BI-508PIWL-**-P)

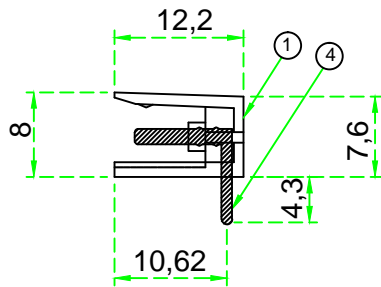

(BI-508PIWS-**-P)

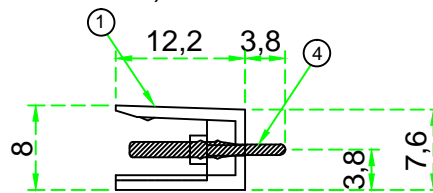

▶ 4, 5, 7, 8, 9p
= 커팅면
▶ 2, 3, 6, 10p
= One Mold

▶ 4, 5, 7, 8, 9p
= 커팅면
▶ 2, 3, 6, 10p
= One Mold

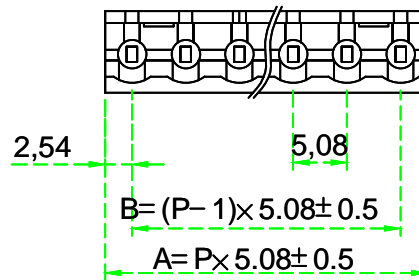
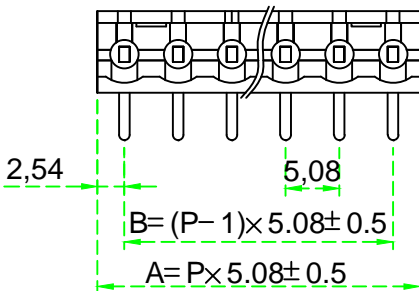

PCB hole Dia: $\phi 1.6$

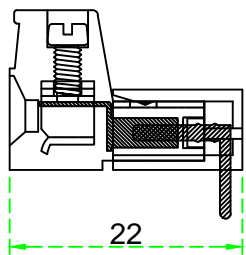

(BI-508PIB &
BI-508PIWL ASS'Y)

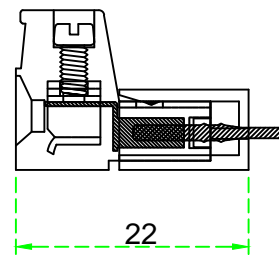

(BI-508PIB &
BI-508PIWS ASS'Y)

NOTE.

1. 지시하지 않은 공차 : General Tolerances

GENERAL TOLERANCES		Part Name.	Dwg No.	
0 ~ 10	±0.3	Terminal block	BI-508PIB-**-P	
10 ~ 50	±0.5		BI-508PIWL-**-P	
50 ~ 100	±0.8		BI-508PIWS-**-P	
	±1.5°	Drawing BY.	Checkd BY.	Approval BY.
Scale		/		
Material				Sheet No. of
Finish				(주)부일일렉트로닉스
				BUIL ELECTRONICS CO., LTD.
				www.ebuil.com